



## Soil Test Map Report - pH

**CARPENTER FARMS LLC** Area: 113.44

Farm: CARPENTER FARMS LLC Sample Date May 20, 2024

Field CRCT113

Lab Name ISTC

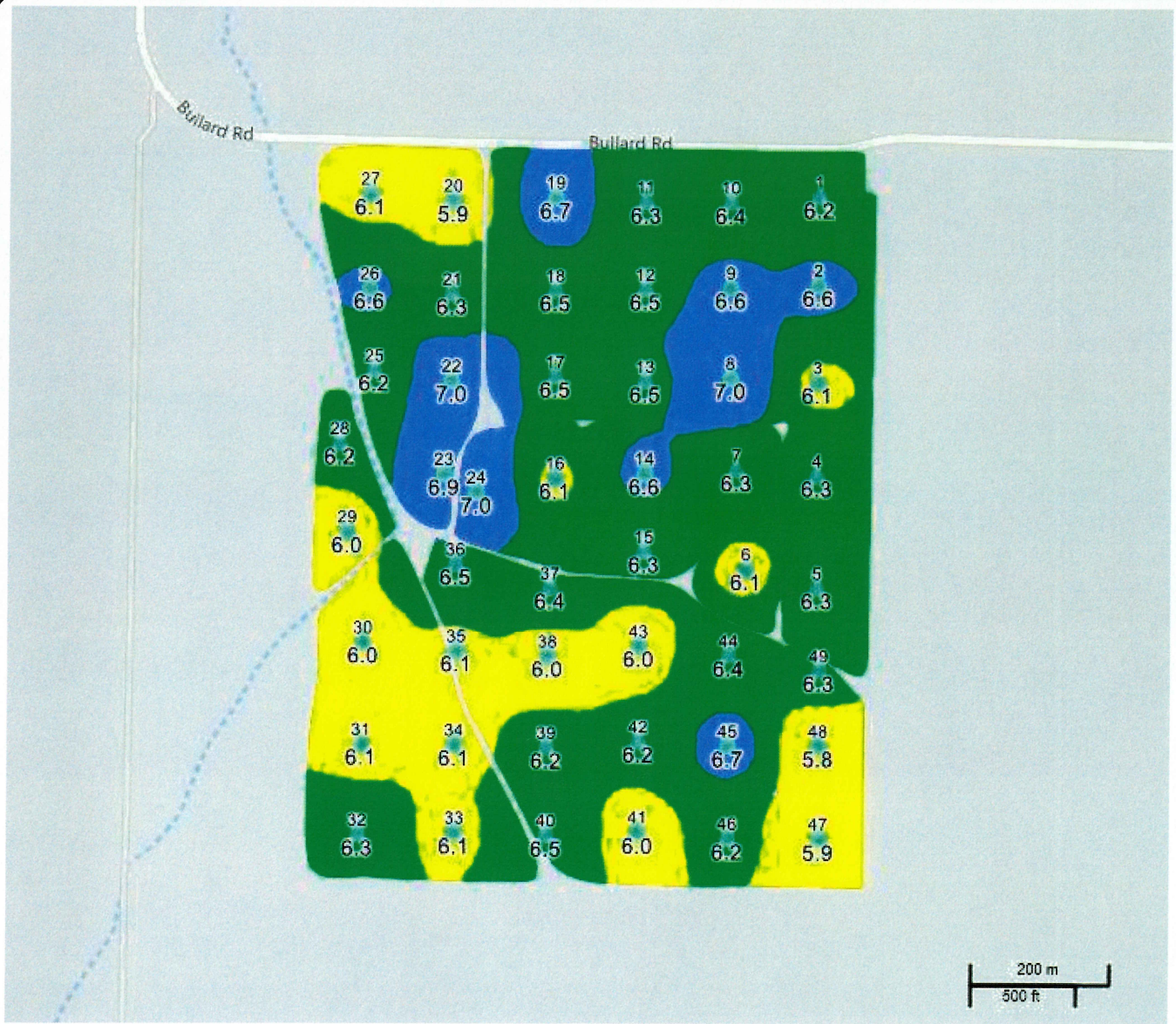

**Location:**

County: Sangamon, IL

Township: Lanesville

Twp Rng Sec: T16N R2W S31

**Summary Statistics**

Layer Name 24 Sites

Sample Count 49

Minimum 5.8

Maximum 7

Average Rate 6.31

Weighted Average: 6.32

**pH none**

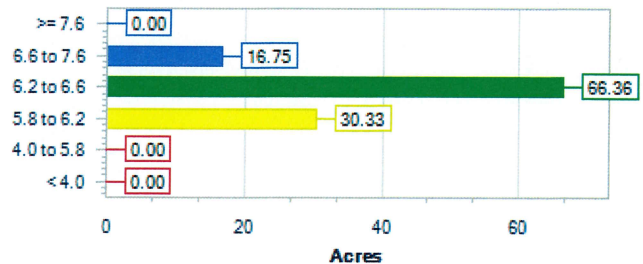



## Soil Test Map Report - P1

CARPENTER FARMS LLC Area: 113.44

Farm: CARPENTER FARMS LLC Sample Date May 20, 2024

Field CRCT113

Lab Name ISTC

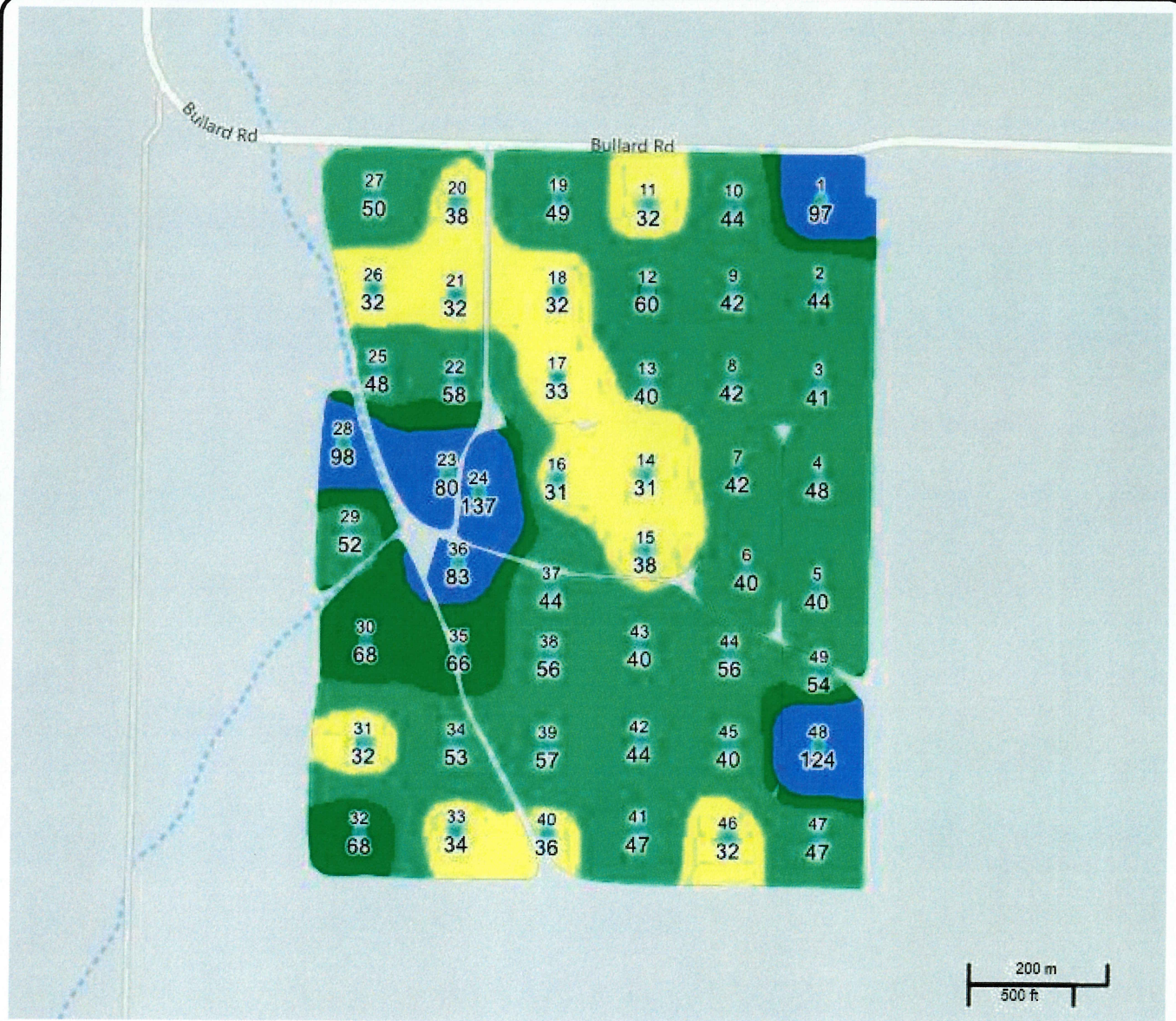

**Location:**

County: Sangamon, IL

Township: Lanesville

Twp Rng Sec: T16N R2W S31

**Summary Statistics**

Layer Name 24 Sites

Sample Count 49

Minimum 31

Maximum 137

Average Rate 50.5

Weighted Average: 50.36

**P1 lbs per acre (st)**

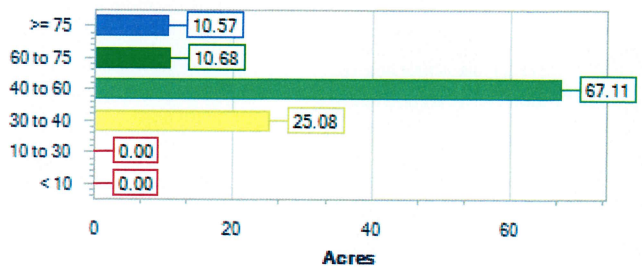



## Soil Test Map Report - K

CARPENTER FARMS LLC Area: 113.44

Farm: CARPENTER FARMS LLC Sample Date May 20, 2024

Field CRCT113

Lab Name ISTC

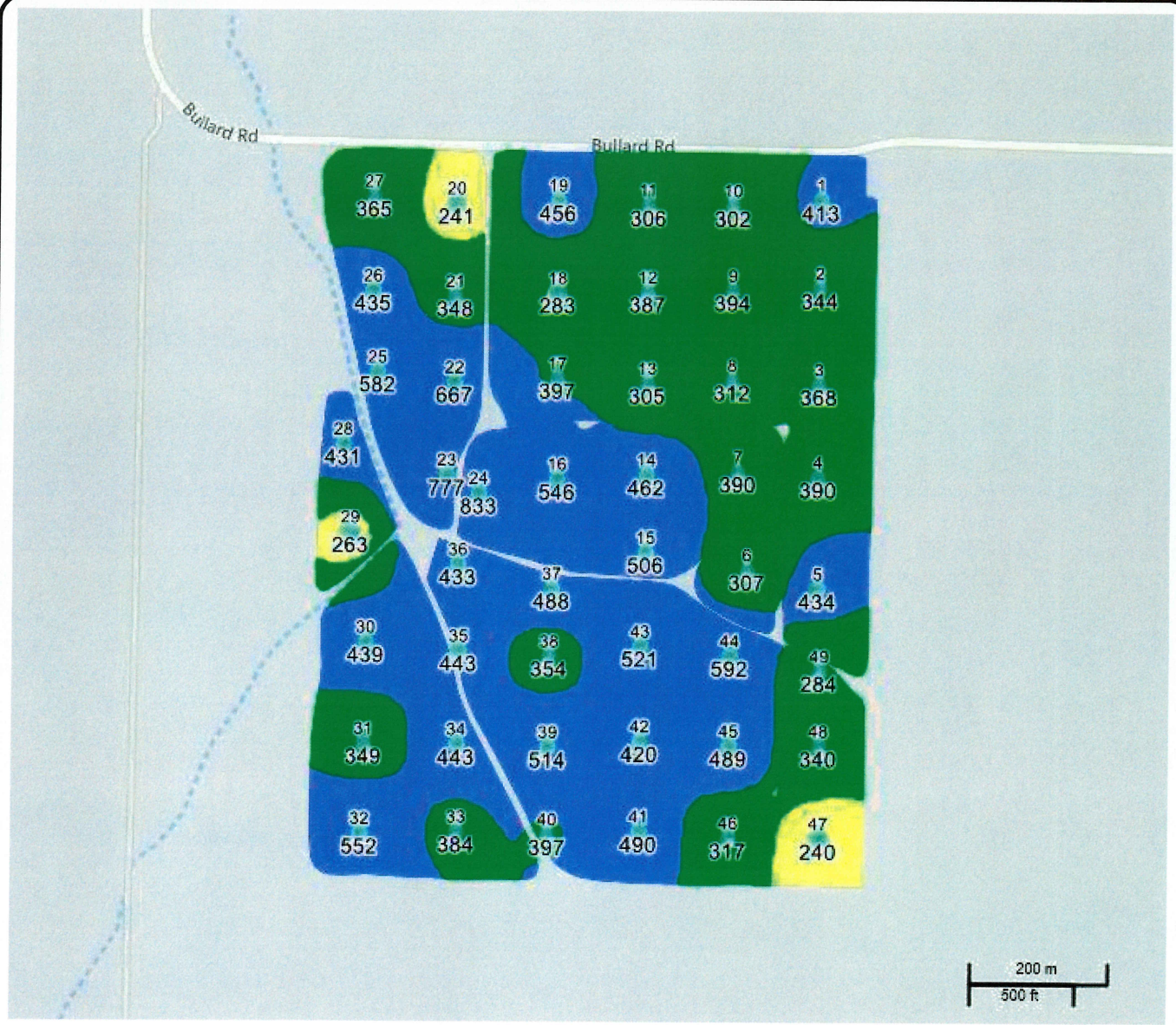

**Location:**

County: Sangamon, IL

Township: Lanesville

Twp Rng Sec: T16N R2W S31

**Summary Statistics**

Layer Name 24 Sites

Sample Count 49

Minimum 240

Maximum 833

Average Rate 417.3

Weighted Average: 417.12

**K lbs per acre (st)**

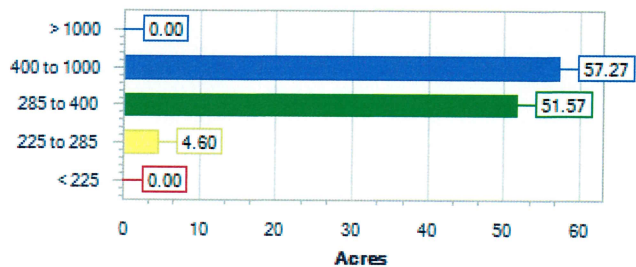

**INGRAM'S SOIL TESTING CENTER**

Box 553  
 924 W. Monroe  
 Sullivan, IL 61951  
 Ph: 217-728-7413  
 Fax: 217-728-2543

13343 Fitschen Road  
 Athens, IL 62613  
 Ph: 217-636-7500  
 Fax: 217-636-7548  
 Email: [istc1@ingramsoil.com](mailto:istc1@ingramsoil.com)

Send To:  
 U.S. BANK  
 205 SO. 5TH STREET  
 SPRINGFIELD, IL 62701



Report Date:  
 05/24/2024  
 Report Number:  
 2401912  
 Operator:  
 CARPENTER FARMS LLC

Farm:  
 CARPENTER FARMS LLC  
 Field:  
 CRCT113  
 Acres:  
 0.00

**SOIL ANALYSIS REPORT**

Sample Number	Lab Number	Organic Matter % ENR (ppm)	Extraction Method: M3				pH		Cation Exchange Capacity	Percent Base Saturation (computed)		
			Phosphorus P (lbs)	Potassium K (lbs)	Magnesium Mg (lbs)	Calcium Ca (lbs)	Soil pH	Buffer pH		% K	%Mg	% Ca
1	24042739	3.2	97	413	503	4203	6.2	6.9	13.8	3.8	15.1	76.0
2	24042740	3.1	44	344	504	5138	6.6	7.0	15.9	2.8	13.2	80.9
3	24042741	3.0	41	368	613	5352	6.1	6.9	17.1	2.8	14.9	78.2
4	24042742	3.2	48	390	529	4701	6.3	6.9	15.5	3.2	14.3	76.0
5	24042743	3.1	40	434	523	4019	6.3	6.9	13.8	4.0	15.8	72.9
6	24042744	2.8	40	307	535	4043	6.1	6.9	13.4	2.9	16.6	75.3
7	24042745	2.9	42	390	520	4298	6.3	6.9	14.4	3.5	15.0	74.6
8	24042746	3.1	42	312	426	3430	7.0	7.0	10.8	3.7	16.5	79.8
9	24042747	3.0	42	394	429	4566	6.6	7.0	14.2	3.6	12.6	80.3
10	24042748	3.1	44	302	411	4412	6.4	7.0	13.6	2.8	12.6	80.9
Field Average:		3.0	47	401	457	4138	6.3	6.9				

Sample Number	Sulfur (ppm)	Boron (ppm)	Zinc (ppm)	Mn (ppm)	Iron (ppm)	Cu (ppm)	Na (ppm)	Element	Average Fertility Level				
									Very Low	Low	Medium	High	Very High
1	13.0	0.5	4.9	93.5	275.8	2.6	14.8	Organic Matter					
2	6.9	0.6	1.0	100.6	149.8	2.0	18.3	Phosphorus			47		
3	7.0	0.4	0.9	70.1	176.0	2.1	13.8	Potassium					401
4	13.2	0.4	0.9	88.8	184.6	2.2	16.8	Magnesium					
5	8.1	0.5	0.5	209.0	140.4	1.7	12.6	Calcium					
6	15.9	0.4	0.4	272.4	148.5	1.6	10.3	ENR					
7	6.4	0.5	0.8	66.2	176.8	2.2	9.3	pH			6.3		
8	7.7	0.3	0.5	137.6	183.9	1.6	11.2						
9	5.8	0.4	0.9	82.8	156.3	1.8	10.9						
10	5.2	0.4	1.0	62.1	164.6	2.0	12.5						

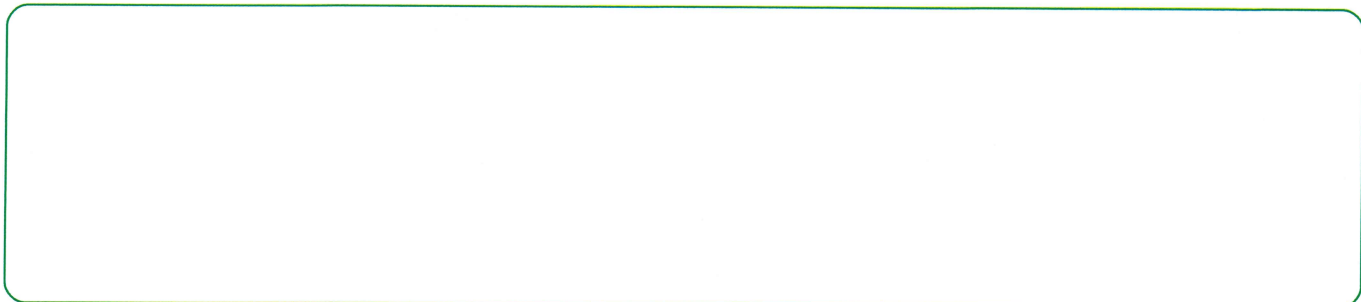

**INGRAM'S SOIL TESTING CENTER**

Box 553  
 924 W. Monroe  
 Sullivan, IL 61951  
 Ph: 217-728-7413  
 Fax: 217-728-2543

13343 Fitschen Road  
 Athens, IL 62613  
 Ph: 217-636-7500  
 Fax: 217-636-7548  
 Email: [istc1@ingramsoil.com](mailto:istc1@ingramsoil.com)

Send To:  
 U.S. BANK  
 205 SO. 5TH STREET  
 SPRINGFIELD, IL 62701

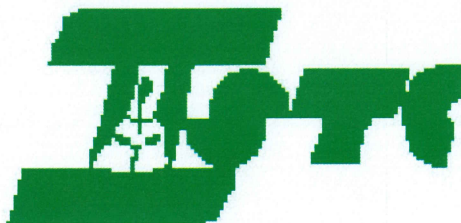

Report Date:  
 05/24/2024  
 Report Number:  
 2401912  
 Operator:  
 CARPENTER FARMS LLC

Farm:  
 CARPENTER FARMS LLC  
 Field:  
 CRCT113  
 Acres:  
 0.00

**SOIL ANALYSIS REPORT**

Sample Number	Lab Number	Organic Matter % ENR (ppm)	Extraction Method: M3				pH		Cation Exchange Capacity	Percent Base Saturation (computed)		
			Phosphorus	Potassium	Magnesium	Calcium	Soil pH	Buffer pH		% K	%Mg	% Ca
			P (lbs)	K (lbs)	Mg (lbs)	Ca (lbs)						
11	24042749	3.0	32	306	396	3871	6.3	6.9	12.7	3.1	13.0	76.1
12	24042750	3.2	60	387	633	5137	6.5	7.0	16.5	3.0	16.0	78.0
13	24042751	3.3	40	305	377	3834	6.5	7.0	12.0	3.2	13.0	79.6
14	24042752	3.0	31	462	496	3923	6.6	7.0	13.0	4.6	15.9	75.6
15	24042753	2.6	38	506	526	4086	6.3	6.9	14.1	4.6	15.6	72.7
16	24042754	2.9	31	546	461	4917	6.1	6.9	15.6	4.5	12.3	78.7
17	24042755	2.8	33	397	416	3807	6.5	7.0	12.3	4.2	14.1	77.6
18	24042756	2.9	32	283	366	3625	6.5	7.0	11.5	3.2	13.3	79.1
19	24042757	2.7	49	456	414	4027	6.7	7.0	12.9	4.5	13.4	78.2
20	24042758	2.8	38	241	315	3787	5.9	6.7	13.2	2.3	10.0	71.8

Field Average:      3.0                      47              401              457              4138      6.3      6.9

Sample Number	Extraction Method: M3							Average Fertility Level					
	Sulfur (ppm)	Boron (ppm)	Zinc (ppm)	Mn (ppm)	Iron (ppm)	Cu (ppm)	Na (ppm)	Element	Very Low	Low	Medium	High	Very High
11	4.7	0.5	0.6	66.5	132.0	1.6	18.4	Organic Matter					
12	5.2	0.5	1.1	74.2	183.0	2.4	18.6	Phosphorus			47		
13	3.7	0.4	0.7	82.7	151.3	1.6	10.0	Potassium					401
14	5.5	0.4	0.8	119.1	138.3	1.7	12.6	Magnesium					
15	9.2	0.4	2.8	134.4	148.7	1.5	12.5	Calcium					
16	7.0	0.5	0.6	123.9	150.6	1.8	14.3	ENR					
17	7.3	0.4	0.5	89.0	155.7	1.5	17.7	pH			6.3		
18	11.2	0.4	1.0	90.0	163.8	1.6	15.1						
19	7.0	0.5	0.9	139.3	165.3	1.8	14.9						
20	13.2	0.4	1.3	68.7	225.8	1.9	11.3						

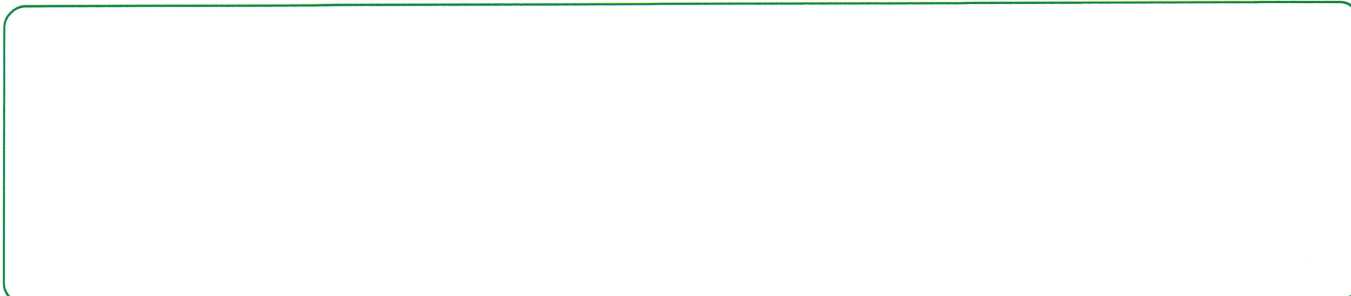

# INGRAM'S SOIL TESTING CENTER

Box 553  
 924 W. Monroe  
 Sullivan, IL 61951  
 Ph: 217-728-7413  
 Fax: 217-728-2543

13343 Fitschen Road  
 Athens, IL 62613  
 Ph: 217-636-7500  
 Fax: 217-636-7548  
 Email: [istc1@ingramsoil.com](mailto:istc1@ingramsoil.com)

Send To:  
 U.S. BANK  
 205 SO. 5TH STREET  
 SPRINGFIELD, IL 62701

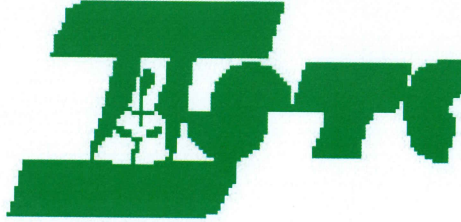

Report Date:  
 05/24/2024  
 Report Number:  
 2401912  
 Operator:  
 CARPENTER FARMS LLC

Farm:  
 CARPENTER FARMS LLC  
 Field:  
 CRCT113  
 Acres:  
 0.00

## SOIL ANALYSIS REPORT

Sample Number	Lab Number	Organic Matter % ENR (ppm)	Extraction Method: M3				pH		Cation Exchange Capacity	Percent Base Saturation (computed)		
			Phosphorus	Potassium	Magnesium	Calcium	Soil pH	Buffer pH		% K	%Mg	% Ca
			P (lbs)	K (lbs)	Mg (lbs)	Ca (lbs)						
21	24042759	3.1	32	348	400	4127	6.3	6.9	13.4	3.3	12.4	76.8
22	24042760	3.0	58	667	266	3414	7.0	7.0	10.5	8.1	10.6	81.3
23	24042761	2.8	80	777	573	3609	6.9	7.0	12.9	7.7	18.5	69.9
24	24042762	3.1	137	833	434	3870	7.0	7.0	12.6	8.5	14.4	77.1
25	24042763	3.0	48	582	282	2619	6.2	6.9	9.5	7.9	12.4	69.1
26	24042764	2.8	32	435	408	4293	6.6	7.0	13.5	4.1	12.6	79.6
27	24042765	3.1	50	365	462	3852	6.1	6.9	12.7	3.7	15.1	75.7
28	24042766	3.2	98	431	371	3815	6.2	6.9	12.3	4.5	12.5	77.3
29	24042767	3.1	52	263	591	3763	6.0	6.8	13.6	2.5	18.1	69.1
30	24042768	2.8	68	439	653	4855	6.0	6.8	16.8	3.3	16.2	72.2

Field Average:      3.0                      47              401              457              4138      6.3      6.9

Sample Number	Extraction Method: M3								Average Fertility Level				
	Sulfur (ppm)	Boron (ppm)	Zinc (ppm)	Mn (ppm)	Iron (ppm)	Cu (ppm)	Na (ppm)	Element	Very Low	Low	Medium	High	Very High
21	8.1	0.5	1.5	94.5	169.4	1.8	13.6	Organic Matter					
22	7.3	0.4	2.4	89.5	192.7	1.6	13.0	Phosphorus			47		
23	5.8	0.6	8.9	113.0	175.2	1.8	11.9	Potassium					401
24	3.9	0.7	9.5	116.5	185.4	3.0	14.9	Magnesium					
25	6.6	0.3	0.5	81.1	148.1	1.2	11.0	Calcium					
26	12.4	0.6	0.4	105.6	139.8	1.4	36.0	ENR					
27	15.9	0.4	0.6	99.5	172.7	1.6	19.4	pH			6.3		
28	8.7	0.3	0.9	125.7	182.0	1.7	11.9						
29	18.8	0.2	0.2	104.9	157.5	1.2	13.6						
30	10.2	0.4	0.3	118.7	153.7	1.6	12.0						

**INGRAM'S SOIL TESTING CENTER**

Box 553  
 924 W. Monroe  
 Sullivan, IL 61951  
 Ph: 217-728-7413  
 Fax: 217-728-2543

13343 Fitschen Road  
 Athens, IL 62613  
 Ph: 217-636-7500  
 Fax: 217-636-7548  
 Email: istc1@ingramsoil.com

Send To:  
 U.S. BANK  
 205 SO. 5TH STREET  
 SPRINGFIELD, IL 62701

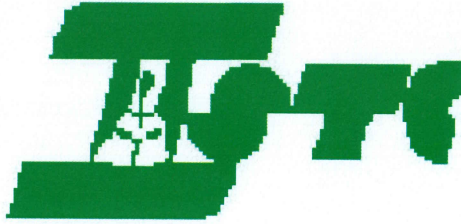

Report Date:  
 05/24/2024  
 Report Number:  
 2401912  
 Operator:  
 CARPENTER FARMS LLC

Farm:  
 CARPENTER FARMS LLC  
 Field:  
 CRCT113  
 Acres:  
 0.00

**SOIL ANALYSIS REPORT**

Sample Number	Lab Number	Organic Matter % ENR (ppm)	Extraction Method: M3				pH		Cation Exchange Capacity	Percent Base Saturation (computed)		
			Phosphorus	Potassium	Magnesium	Calcium	Soil pH	Buffer pH		% K	%Mg	% Ca
			P (lbs)	K (lbs)	Mg (lbs)	Ca (lbs)						
31	24042769	2.9	32	349	399	3758	6.1	6.9	12.2	3.7	13.6	77.0
32	24042770	3.1	68	552	450	4829	6.3	6.9	15.7	4.5	12.0	77.1
33	24042771	2.8	34	384	362	3616	6.1	6.9	11.7	4.2	12.9	77.0
34	24042772	3.1	53	443	693	5905	6.1	6.9	18.9	3.0	15.3	78.0
35	24042773	3.2	66	443	360	3323	6.1	6.8	11.8	4.8	12.7	70.6
36	24042774	2.7	83	433	654	3789	6.5	7.0	13.3	4.2	20.6	71.5
37	24042775	3.0	44	488	443	3947	6.4	7.0	12.8	4.9	14.4	76.8
38	24042776	2.9	56	354	382	4303	6.0	6.8	14.2	3.2	11.2	75.7
39	24042777	2.7	57	514	445	4057	6.2	6.9	13.7	4.8	13.6	74.3
40	24042778	2.9	36	397	427	4264	6.5	7.0	13.5	3.8	13.2	79.3

Field Average:      3.0                      47              401              457              4138      6.3      6.9

Sample Number	Extraction Method: M3							Average Fertility Level					
	Sulfur (ppm)	Boron (ppm)	Zinc (ppm)	Mn (ppm)	Iron (ppm)	Cu (ppm)	Na (ppm)	Element	Very Low	Low	Medium	High	Very High
31	9.1	0.3	0.6	101.2	180.1	1.8	10.7	Organic Matter					
32	7.9	0.5	1.5	89.8	238.4	2.5	13.6	Phosphorus			47		
33	18.3	0.3	7.7	200.2	178.2	2.0	14.5	Potassium					401
34	7.9	0.6	1.5	203.4	154.8	2.5	13.5	Magnesium					
35	10.4	0.3	0.8	153.8	205.0	1.8	11.2	Calcium					
36	16.3	0.5	3.1	155.5	210.1	1.9	13.5	ENR					
37	10.6	0.4	1.4	207.8	145.4	1.5	18.1	pH			6.3		
38	7.4	0.5	0.5	190.0	134.0	1.8	9.7						
39	14.0	0.5	0.4	210.2	153.5	1.6	11.8						
40	6.1	0.3	0.5	190.2	144.1	1.6	12.5						

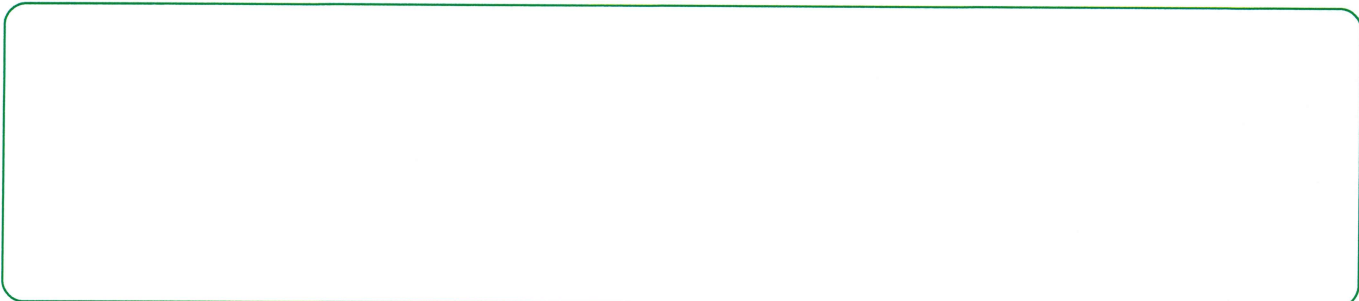

# INGRAM'S SOIL TESTING CENTER

Box 553  
 924 W. Monroe  
 Sullivan, IL 61951  
 Ph: 217-728-7413  
 Fax: 217-728-2543

13343 Fitschen Road  
 Athens, IL 62613  
 Ph: 217-636-7500  
 Fax: 217-636-7548  
 Email: [istc1@ingramsoil.com](mailto:istc1@ingramsoil.com)

Send To:  
 U.S. BANK  
 205 SO. 5TH STREET  
 SPRINGFIELD, IL 62701

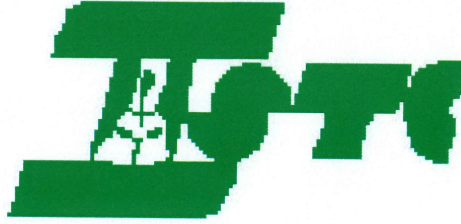

Report Date:  
 05/24/2024  
 Report Number:  
 2401912  
 Operator:  
 CARPENTER FARMS LLC

Farm:  
 CARPENTER FARMS LLC  
 Field:  
 CRCT113  
 Acres:  
 0.00

## SOIL ANALYSIS REPORT

Sample Number	Lab Number	Organic Matter % ENR (ppm)	Extraction Method: M3				pH		Cation Exchange Capacity	Percent Base Saturation (computed)		
			Phosphorus	Potassium	Magnesium	Calcium	Soil pH	Buffer pH		% K	%Mg	% Ca
			P (lbs)	K (lbs)	Mg (lbs)	Ca (lbs)						
41	24042779	2.8	47	490	404	3801	6.0	6.8	13.2	4.8	12.7	71.9
42	24042780	3.0	44	420	367	3841	6.2	6.9	12.7	4.3	12.1	75.8
43	24042781	3.2	40	521	297	3689	6.0	6.7	13.2	5.1	9.4	69.7
44	24042782	3.1	56	592	384	4999	6.4	7.0	15.4	4.9	10.4	81.4
45	24042783	2.8	40	489	437	5251	6.7	7.0	16.1	3.9	11.3	81.7
46	24042784	3.2	32	317	426	4664	6.2	6.9	14.5	2.8	12.2	80.2
47	24042785	3.1	47	240	412	3588	5.9	6.7	13.1	2.4	13.1	68.5
48	24042786	3.3	124	340	369	3355	5.8	6.5	13.9	3.1	11.1	60.5
49	24042787	3.2	54	284	834	4393	6.3	6.9	15.8	2.3	22.0	69.4

Field Average:      3.0                      47              401              457              4138      6.3      6.9

Sample Number	Extraction Method: M3							Average Fertility Level					
	Sulfur (ppm)	Boron (ppm)	Zinc (ppm)	Mn (ppm)	Iron (ppm)	Cu (ppm)	Na (ppm)	Element	Very Low	Low	Medium	High	Very High
41	13.8	0.4	0.9	226.5	142.1	1.5	47.0	Organic Matter					
42	6.6	0.4	0.8	72.7	204.1	1.9	10.1	Phosphorus			47		
43	12.9	0.3	1.0	106.6	208.0	1.9	12.5	Potassium					401
44	11.7	0.5	0.9	202.1	166.0	2.1	12.3	Magnesium					
45	5.9	0.5	0.8	140.1	162.5	1.9	10.8	Calcium					
46	6.8	0.5	0.8	103.9	167.3	1.7	11.7	ENR					
47	11.7	0.2	0.4	78.8	179.8	1.5	11.8	pH			6.3		
48	8.6	0.3	0.5	54.5	180.4	1.8	15.0						
49	8.1	0.6	1.5	97.3	273.1	2.8	20.7						

